

33 769 000 **PÁKOVÉPODOMIETKOVÉ UNIVERZÁLNE MONTÁŽNE TELESO, DN 15**

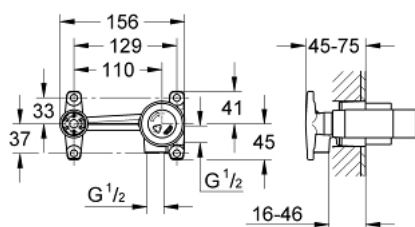

**POPIS PRODUKTU**

- Colour: chrom
- for 2-hole basin mixers
- wall installation
- without finishing trim set
- GROHE SilkMove 46 mm ceramic cartridge
- adjustable flow rate limiter
- installation depth 45 to 75 mm
- installation device



33 769 000 **PÁKOVÉPODOMIETKOVÉ UNIVERZÁLNE MONTÁŽNE TELESO, DN 15**

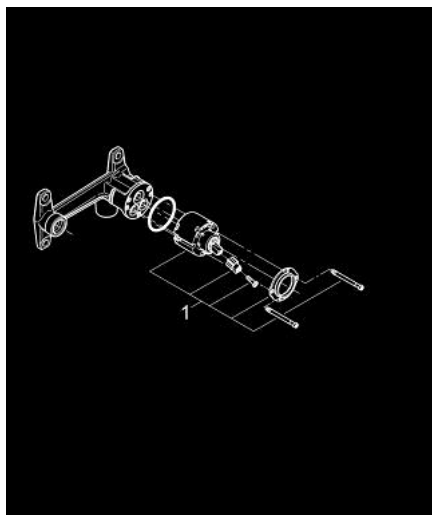

**NÁHRADNÉ DIELY** , apríla 2005 – now

1: Kartuša (Č. obj. 46048000)