

## A modern, single-lever chrome faucet with a sleek, curved design. The faucet has a polished chrome finish and a side sprayer attachment. The handle is a single lever that curves over the spout. The spout is curved and has a side sprayer attachment. The faucet is set against a white background.

- Colour: chrom
- single hole installation
- metal lever
- GROHE SilkMove 35 mm ceramic cartridge
- Povrchová úprava GROHE Long-Life
- adjustable flow rate limiter
- adjustable minimum flow rate approx. 2.5 l/min
- ball-joint mousseur
- pop-up waste set 1 1/4"
- flexible connection hoses
- rapid installation system
- optional temperature limiter ref. no. 46 375
- noise classification I in accordance with DIN 4109

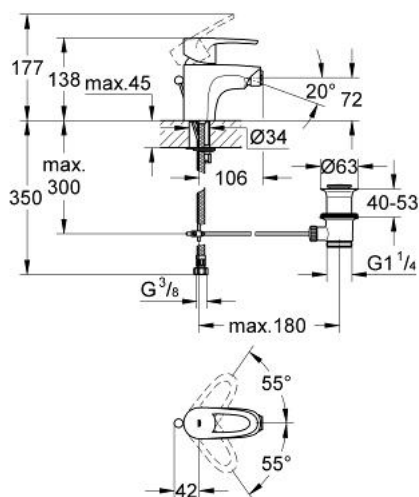

## 33 241 001 EUROPLUS PÁKOVÁ BIDETOVÁ BATÉRIA, DN 15

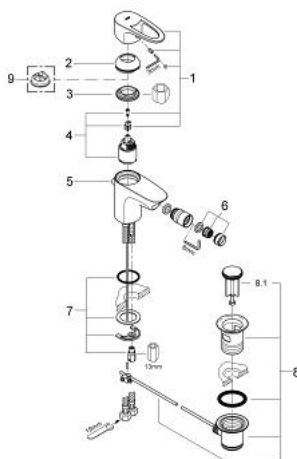

### NÁHRADNÉ DIELY , augusta 2008 – now

- 1: Kompletná páka (Č. obj. 46569000)
- 2: Kryt (Č. obj. 46570000)
- 3: Nastaviteľné ELB, DN 10 (Č. obj. 46460000)
- 4: Kartúša (Č. obj. 46374000)
- 5: Tiahlo (Č. obj. 65412000)
- 6: Perlátor (Č. obj. 13929000)
- 7: Kontraskrutkový spoj (Č. obj. 46249000)
- 8: odpadová garnitúra (Č. obj. 28915000)
- 8.1: Zátka (Č. obj. 45210000)
- 9: Obmedzovač teploty (Č. obj. 46375000)\*

\* Voliteľné príslušenstvo