

## A high-quality, modern chrome faucet with a curved spout and a single-lever handle, set against a white background. The faucet has a sleek, minimalist design with a polished chrome finish. The spout is tall and curves gracefully to the right. The handle is a single lever that extends horizontally from the base of the spout. The base of the faucet is a solid, cylindrical column. The overall aesthetic is clean and contemporary.

- Colour: chrom
- single hole installation
- adjustable flow rate limiter
- swivel tubular spout with stop limiter
- mousseur
- flexible connection hoses
- pop-up waste set 1 1/4"
- rapid installation system
- covered lever fixing
- optional temperature limiter ref. no. 46 375
- Povrchová úprava GROHE Long-Life
- GROHE SilkMove 35 mm ceramic cartridge

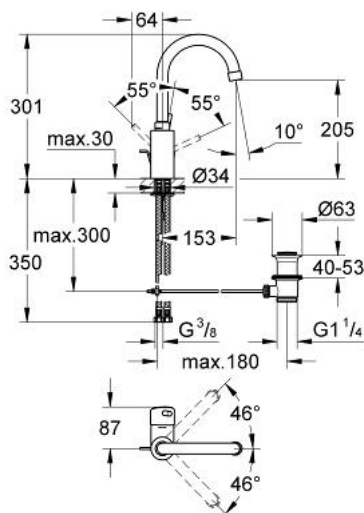

## 32 629 000 **CONCETTO PÁKOVÁ UMÝVADLOVÁ BATÉRIA, DN 15**

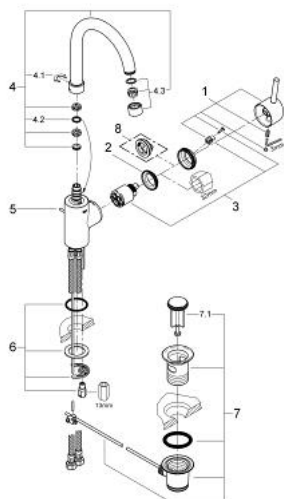

### **NÁHRADNÉ DIELY** , augusta 2007 – now

- 1: Kompletná páka (Č. obj. 46630000)
- 2: Nastaviteľné ELB, DN 10 (Č. obj. 46460000)
- 3: Kartuša (Č. obj. 46374000)
- 4: Výtoková trubica (Č. obj. 46631000)
- 4.1: Zaisťovací krúžok (Č. obj. 0806500M)
- 4.2: Krycí krúžok (Č. obj. 0128500M)
- 4.3: Perlátor (Č. obj. 13993000)
- 5: Tiahlo (Č. obj. 10769000)
- 6: Kontraskrutkový spoj (Č. obj. 46249000)
- 7: odpadová garnitúra (Č. obj. 28915000)
- 7.1: Zátka (Č. obj. 45210000)
- 8: Obmedzovač teploty (Č. obj. 46375000)\*

\* Voliteľné príslušenstvo