

32 287 000 **WAVE PÁKOVÁ SPRCHOVÁ BATÉRIA, DN 15**

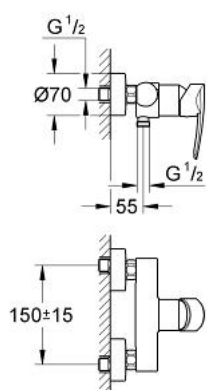

POPIS PRODUKTU

- Colour: chrom
- wall mounted
- metal lever
- GROHE SilkMove 46 mm ceramic cartridge
- Povrchová úprava GROHE Long-Life
- adjustable flow rate limiter
- adjustable minimum flow rate approx. 2.5 l/min
- shower bottom outlet 1/2" with integrated non return valve
- S-unions
- metal wall escutcheons
- optional temperature limiter ref. no. 46 375
- protected against backflow



32 287 000 **WAVE PÁKOVÁ SPRCHOVÁ BATÉRIA, DN 15**

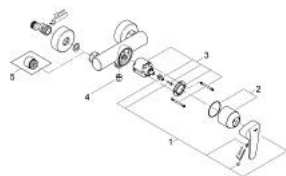

NÁHRADNÉ DIELY , júna 2008 – now

1: Kompletná páka (Č. obj. 46605000)

2: Kryt (Č. obj. 46578000)

3: Kartúša (Č. obj. 46048000)

4: Spätná klapka (Č. obj. 08565000)

5: Predĺženie DN 20, 20 mm (Č. obj. 0713000M)*

* Voliteľné príslušenstvo