

32 209 001 **CONCETTO PÁKOVÁ BIDETOVÁ BATÉRIA, DN 15** **S-SIZE**

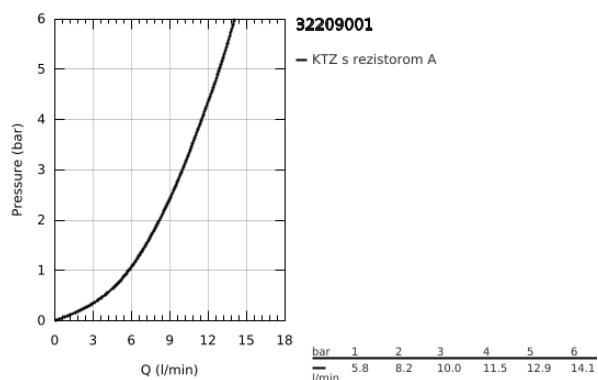

POPIS PRODUKTU

- Colour: chrom
- single hole installation
- metal lever
- GROHE SilkMove 28 mm ceramic cartridge
- Povrchová úprava GROHE Long-Life
- ball-joint mousseur
- retractable chain
- flexible connection hoses
- GROHE FastFixation installation system with centering support
- optional temperature limiter
- noise classification I in accordance with DIN 4109

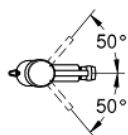
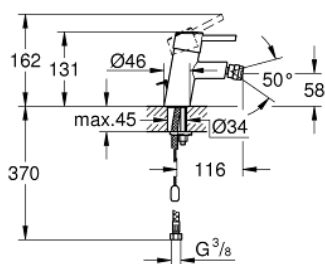

32 209 001 **CONCETTO PÁKOVÁ BIDETOVÁ BATÉRIA, DN 15** **S-SIZE**

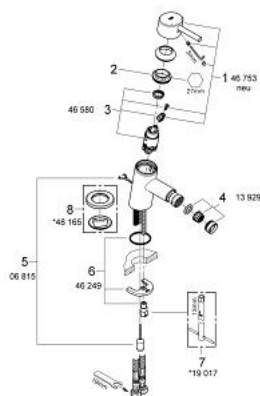

NÁHRADNÉ DIELY , apríla 2010 – now

- 1: Kompletná páka (Č. obj. 46753000)
 - 2: Upevň.krúžok (Č. obj. 46715000)
 - 3: Kartúša (Č. obj. 46580000)
 - 4: Perlátor (Č. obj. 13929000)
 - 5: Retiazka (Č. obj. 06815000)
 - 6: Kontraskrutkový spoj (Č. obj. 46249000)
 - 7: Montážny kľúč (Č. obj. 19017000)*
 - 8: rozeta (Č. obj. 48165000)*
- * Voliteľné príslušenstvo