

23 270 000 SWIFT PÁKOVÁ VAŇOVÁ BATÉRIA, DN 15

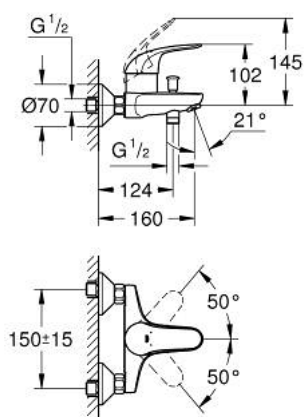

POPIS PRODUKTU

- Colour: chrom
- wall mounted
- metal lever
- GROHE SilkMove 46 mm ceramic cartridge
- adjustable flow rate limiter
- GROHE Long-Life finish
- automatic diverter: bath/shower
- výstup sprchy DN 15 s integrovaným spätným ventilom
- mousseur
- S-unions
- optional temperature limiter ref. no. 46 308
- protected against backflow
- noise classification I in accordance with DIN 4109
- vrátane nástroja GROHE QuickSpanner

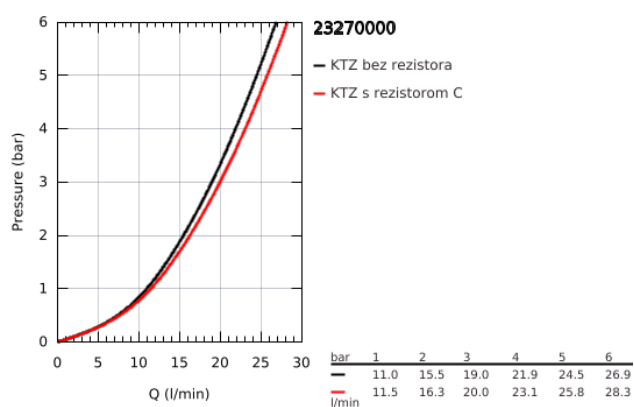

This exploded view diagram illustrates the assembly of a vacuum cleaner. The components are numbered as follows:

- 1**: Main body housing.
- 2**: Motor assembly.
- 3**: Upper filter assembly.
- 4**: Lower filter assembly.
- 5**: Motor drive shaft.
- 6**: Motor drive pulley.
- 7**: Motor drive belt.
- 8**: Motor drive pulley.
- 9**: Motor drive pulley.
- 10**: Motor drive pulley.
- 11**: Motor drive pulley.
- 12**: Motor drive pulley.

The diagram shows the motor assembly (2) connected to the main body (1) via a drive shaft (5) and pulleys (6, 8, 9, 10, 11, 12). The filter assembly (3, 4) is shown attached to the main body. The motor drive belt (7) is shown around the pulleys (6, 8, 9, 10, 11, 12).

- 1: Kompletná páka (Č. obj. 46644000)
- 2: Kryt (Č. obj. 46578000)
- 3: Kartuša (Č. obj. 46048000)
- 4: Prepínanie (Č. obj. 65648000)
- 5: Prepínanie (Č. obj. 65655000)
- 6: Spätná klapka (Č. obj. 08565000)
- 7: Perlátor (Č. obj. 13952000)
- 8: Prípojný skrutkový spoj DN 15 (Č. obj. 45044000)
- 9: S-prípojka (Č. obj. 12075000)
- 9.1: Tesnenie (Č. obj. 0138600M)
- 9.2: Rozeta (Č. obj. 0221000M)
- 10: Obmedzovač teploty (Č. obj. 46375000)*
- 11: Predĺženie DN 20, 20 mm (Č. obj. 0713000M)*
- 12: špeciálny kľúč (Č. obj. 19377000)*

* Voliteľné príslušenstvo